

Kirby Morgan 37SS Helmet P/N 500-100 / 500-101

Location #	Part #	Description
1	510-575	Nose Block Pad
2	545-015	Nose Block Device <i>Includes location #1</i>
3	520-020	Valve Body
4	510-550	Valve, Oral Nasal
5	510-747	Oral Nasal Mask
6	530-058	Screw
7	330-405	Washer, Lock
8	540-579	Handle, Helmet, KM 37SS
9	530-059	Screw
10	510-795	Grip, Handle
11	430-075	Washer
12	530-052	Screw
13	505-765	Handle Assembly, KM 37SS
14	560-517	Helmet Shell, Stainless Steel
15	505-753	Airtrain Assembly, Stainless Helmet
16	550-571	Sleeve
17	530-083	Screw
18	550-574	Sleeve
19	530-535	Washer
20	530-415	Washer
21	530-317	Nut
22	540-563	Port Retainer
23	530-059	Screw
24	550-566	Adapter
25	530-052	Screw
26	550-062	Knob, Nose Block
27	555-180	Packing Nut, Nose Block
28	510-008	O-ring
29	550-577	Nose Block Guide
30	505-738	Port Retainer Assembly
31	510-010	O-ring
32	520-004	Face Port
33	510-260	O-ring, View Port
34	550-081	Regulator Mount Nut
35	510-490	O-ring
36	550-097	Large Port Plug Body
37	510-029	O-ring
38	510-481	O-ring
39	550-043	Plug
40	320-026	Comm. Mount Nut
41	505-089	Large Port Plug Assembly <i>Includes location #s 36-40</i>
42	530-145	Nut

Location #	Part #	Description
43	530-527	Washer
44	510-403	Gasket, Pod
45	540-012	Retainer Ring
46	520-022	Exhaust Valve Insert
47	510-776	Exhaust Valve
48	510-019	O-ring
49	560-556	Regulator Mount Pod, 350
50	520-042	Tie Wrap
51	430-134	Washer
52	530-089	Screw
53	530-086	Screw
54	520-042	Tie Wrap
55	520-200	Valve Seat
56	510-776	Exhaust Valve
57	530-008	Brass Screw
58	520-118	Tri/Quad Valve Whisker Clamp
59	510-787	Port Whisker Wing
60	540-015	Kidney Plate
61	550-586	Spacer, Whisker
62	530-070	Screw
63	560-300	Zinc Whisker Anode
64	530-009	Brass Nut
65	505-069	Regulator Assembly, 1" Mount Tube <i>Purchase 525-771</i>
66	510-760	Main Body Quad Valve Exhaust
67	510-786	Starboard Whisker Wing
68	505-730	Quad Valve Exhaust Assembly <i>350 Regulator Pod Assembly</i>
69	505-758	<i>Also includes location #s 34 and 35 (Order P/N 525-385)</i>
70	530-145	Lock Nut
71	530-086	Screw
72	530-032	Screw
73	530-035	Screw
74	530-546	Washer for Swing Catch
75	550-061	Spacer
76	540-086	Swing Catch
77	520-167	Teflon® Washer for Swing Catch
78	535-825	Spring, Swing Catch
79	550-122	Spring Spacer
80	530-045	Screw
81	505-748	Chin Strap Assembly, w/ Snaps, S.S.
82	530-028	Lock Nut
83	505-755	Locking Collar Assembly, S.S.

Location #	Part #	Description
84	530-027	Hinge Bolt
85	520-165	Washer
86	530-545	Washer
87	505-746	Neck Ring Assembly, Medium, S.S.
88	530-037	Screw
89	505-742	Earphone Retainer Assembly, S.S.
90	505-740	Snap Assembly, S.S.
91	505-110	Sealed Pull Pin Assembly
92	530-059	Screw
93	540-039	Front Stand Off
94	525-116	Front Stand Off Kit <i>(2 each of Loc. # 92 and 93)</i>
95	530-015	Screw
96	320-026	Comm. Mount Nut
97	515-018	Earphone, Right, 9"
98	515-019	Earphone, Left, 15.5"
99	515-029	Microphone Assembly
100	515-024	Comm. Assembly w/MWP
101	515-023	Comm. Assembly w/Posts
102	505-732	Side block Assembly
103	520-033	O-ring, Teflon®
104	555-154	Bent Tube Assembly, No O-rings
105	510-012	O-ring
106	555-155	Bent Tube Assembly w/O-rings
107	560-304	Zinc Sleeve Anode
108	520-038	Tie Wrap
109	510-683	Chin Cushion Assembly
	510-639	Chin Cushion Bag
110	510-837	Head Cushion Foam Spacer Assembly <i>(Order P/N 525-745)</i>
	510-836	Head Cushion Foam Spacer Bag
111	510-754	Head Cushion Assembly
	510-722	Head Cushion Bag

⚠ CAUTION

Use only Kirby Morgan original replacement parts. The use of other manufacturers' parts will interfere with the performance characteristics of your life support equipment and may jeopardize your safety. Additionally, any substitutions will void any warranties offered by KMDSI. When ordering spares, always insist on Kirby Morgan original parts.



Kirby Morgan Dive Systems, Inc.® 1430 Jason Way, Santa Maria, CA 93455

Phone: 805/928-7772 Fax: 805/928-0342

www.KirbyMorgan.com e-mail: kmdsi@KirbyMorgan.com

Kirby Morgan 37SS Helmet

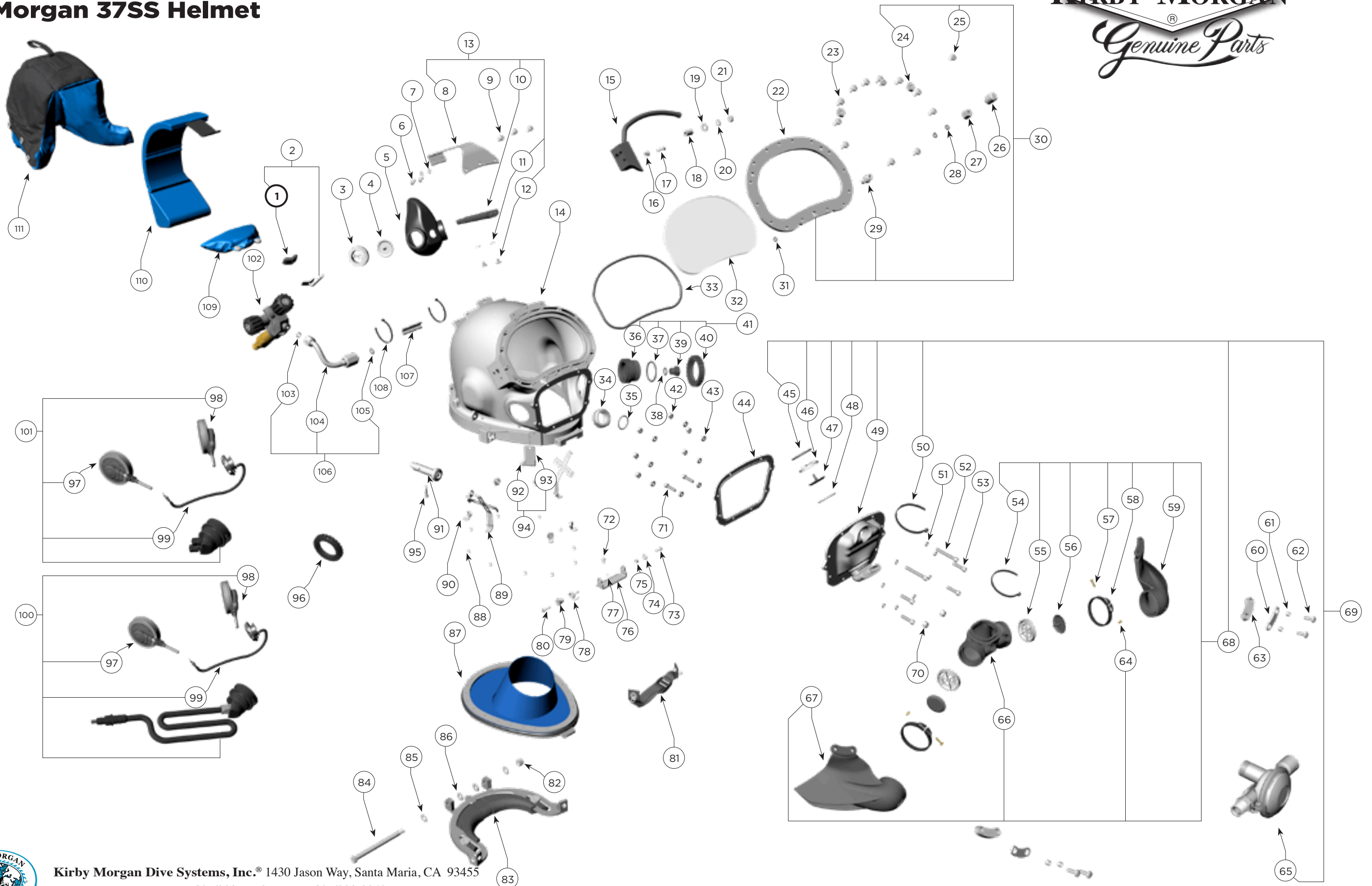

Kirby Morgan Dive Systems, Inc.® 1430 Jason Way, Santa Maria, CA 93455

Phone: 805/928-7772 Fax: 805/928-0342

www.KirbyMorgan.com e-mail: kmdsi@KirbyMorgan.com