

Kirby Morgan 97 Helmet

P/N 500-700 / 500-701

Location #	Part #	Description
1	510-575	Nose Block Pad
2	545-015	Nose Block Device <i>Includes location #1</i>
3	520-020	Valve Body
4	510-550	Valve, Oral Nasal
5	510-747	Oral Nasal Mask
6	530-058	Screw
7	330-405	Washer, Lock
8	540-591	Handle, Helmet, KM 97
9	530-059	Screw
10	510-795	Grip, Handle
11	430-075	Washer
12	530-052	Screw
13	505-766	Handle Assembly, KM 97
14	560-517*	Helmet Shell, Stainless Steel
15	505-753	Airtrain Assembly, Stainless Helmet
16	550-571	Sleeve
17	530-083	Screw
18	550-574	Sleeve
19	530-535	Washer
20	530-415	Washer
21	530-317	Nut
22	540-563	Port Retainer
23	530-059	Screw
24	550-566	Adapter
25	530-052	Screw
26	550-062	Knob, Nose Block
27	555-180	Packing Nut, Nose Block
28	510-008	O-ring
29	550-577	Nose Block Guide
30	505-738	Port Retainer Assembly
31	510-010	O-ring
32	520-004*	Face Port
33	510-260	O-ring, View Port
34	550-097	Large Port Plug Body
35	510-029	O-ring
36	510-481	O-ring
37	550-043	Plug
38	320-026	Comm. Mount Nut
39	505-089	Large Port Plug Assembly <i>Includes location #s 34-38</i>
40	550-081	Regulator Mount Nut
41	510-490	O-ring
42	530-145	Nut

Location #	Part #	Description
43	530-527	Washer
44	510-403	Gasket, Pod
45	540-012	Retainer Ring
46	520-022	Exhaust Valve Insert
47	510-776	Exhaust Valve
48	510-019	O-ring
49	560-556	Regulator Mount Pod, 350
50	520-042	Tie Wrap
51	430-134	Washer
52	530-089	Screw
53	530-086	Screw
54	520-042	Tie Wrap
55	520-200	Valve Seat
56	510-776	Exhaust Valve
57	530-008	Brass Screw
58	520-118	Tri/Quad Valve Whisker Clamp
59	510-787	Port Whisker Wing
60	550-586	Spacer, Whisker
61	530-070	Screw
62	560-300	Zinc Whisker Anode
63	530-009	Brass Nut
64	505-455	455 Balanced Regulator <i>(Order P/N 525-765)</i>
65	510-760	Main Body Quad Valve Exhaust
66	510-786	Starboard Whisker Wing
67	505-730	Quad Valve Exhaust Assembly 455 Regulator Pod Assembly <i>Also includes location #s 40 and 41 (Order P/N 525-769)</i>
68	505-776	
69	530-145	Lock Nut
70	530-086	Screw
71	530-032	Screw
72	530-035	Screw
73	530-546	Washer for Swing Catch
74	550-061	Spacer
75	540-086	Swing Catch
76	520-167	Teflon® Washer for Swing Catch
77	535-825	Spring, Swing Catch
78	550-122	Spring Spacer
79	530-045	Screw
80	505-748	Chin Strap Assembly, w/ Snaps, S.S.
81	530-028	Lock Nut
82	505-755	Locking Collar Assembly, S.S.
83	530-027	Hinge Bolt

Location #	Part #	Description
84	530-545	Washer
85	520-165	Washer
86	505-746	Neck Ring Assembly, Medium, S.S.
87	530-037	Screw
88	505-742	Earphone Retainer Assembly, S.S.
89	505-740	Snap Assembly, S.S.
90	505-110	Sealed Pull Pin Assembly
91	530-059	Screw
92	540-039	Front Stand Off
93	525-116	Front Stand Off Kit <i>(2 each of Loc. # 91 and 92)</i>
94	530-015	Screw
95	320-026	Comm. Mount Nut
96	515-018	Earphone, Right, 9"
97	515-019	Earphone, Left, 15.5"
98	515-029	Microphone Assembly
99	515-024	Comm. Assembly w/MWP
100	515-023	Comm. Assembly w/Posts
101	505-732	Side block Assembly
102	520-033	O-ring, Teflon®
103	555-154	Bent Tube Assembly, No O-rings
104	510-012	O-ring
105	555-155	Bent Tube Assembly w/O-rings
106	560-304	Zinc Sleeve Anode
107	520-038	Tie Wrap
108	510-683	Chin Cushion Assembly
	510-639	Chin Cushion Bag
109	510-837	Head Cushion Foam Spacer Assembly <i>(Order P/N 525-745)</i>
	510-836	Head Cushion Foam Spacer Bag
110	510-754	Head Cushion Assembly
	510-722	Head Cushion Bag

⚠ CAUTION

Use only Kirby Morgan original replacement parts. The use of other manufacturers' parts will interfere with the performance characteristics of your life support equipment and may jeopardize your safety. Additionally, any substitutions will void any warranties offered by KMDSI. When ordering spares, always insist on Kirby Morgan original parts.

* Denotes a critical component



Kirby Morgan Dive Systems, Inc.® 1430 Jason Way, Santa Maria, CA 93455

Phone: 805/928-7772 Fax: 805/928-0342

www.KirbyMorgan.com e-mail: kmdsi@KirbyMorgan.com

Kirby Morgan 97 Helmet

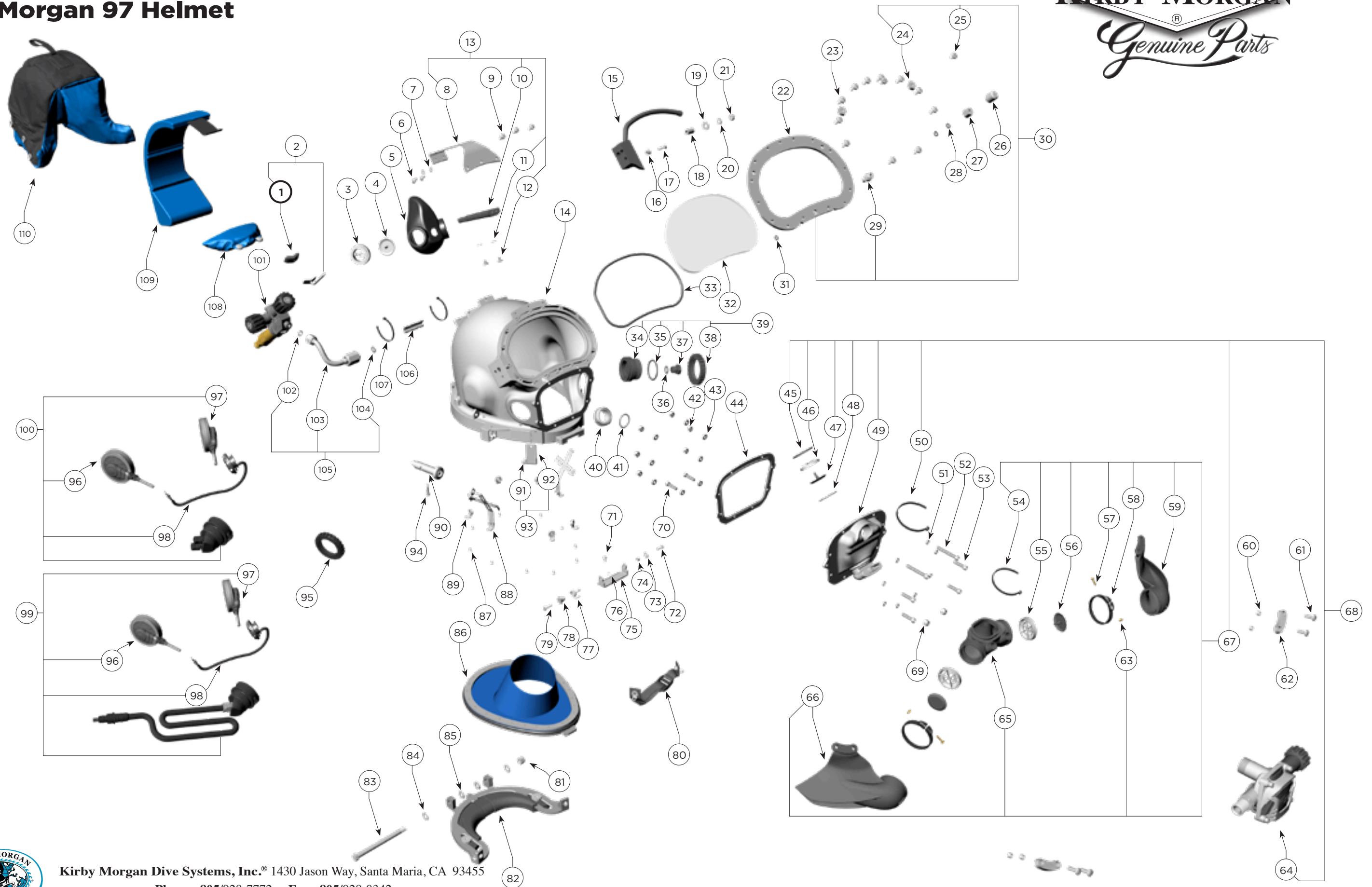

Kirby Morgan Dive Systems, Inc.® 1430 Jason Way, Santa Maria, CA 93455

Phone: 805/928-7772 Fax: 805/928-0342

www.KirbyMorgan.com e-mail: kmdsi@KirbyMorgan.com